

A Church Building for Everyone

Third Century Team Proposal



Twenty-seven months ago, we added OPEN ACCESS to Open Minds, Hearts, and Arms



Our church trustees accomplished a LOT!

- **Waterproofing the sanctuary foundation**
- **Building an ADA compliant ramp**
- **Laying new sidewalks**
- **Installing a motorized chair lift**
- **Replacing the main entrance doors**
- **Building a new accessible restroom downstairs**
- **Adding two controllable video cameras**

Our church trustees accomplished a LOT!

***Completed with
much volunteer
labor...***

-
- Building
- Laying
-
- Replacing the
- Building a new accessible restroom downstairs
- Adding two controllable video cameras

Our church trustees accomplished a LOT!

*...but all without
a Capital
Campaign!*

-
- Building
- Laying
-
- Replacing the
- Building a new accessible restroom downstairs
- Adding two controllable video cameras

However

...

...the task is not complete!

- The chancel and second floor levels can't be reached without *stairs*.
- Our friends with limited mobility need time and energy to reach them.
- Friends in wheelchairs can't reach them at all.
- The chair lift requires transfers.
- The new restroom is central, not near entrances or exits.

However

...

**That is our
WHY!
We believe
that ALL
really
means ALL!**

...the task is not complete!

- The chancel and second floor levels can't be reached without *stairs*.
- Our friends with limited mobility need time and energy to reach them.
- Friends in wheelchairs can't reach them at all.
- The chair lift requires transfers.
- The new restroom is central, not near entrances or exits.

Mantua Center Christian Church Third Century Plan – Phase Two

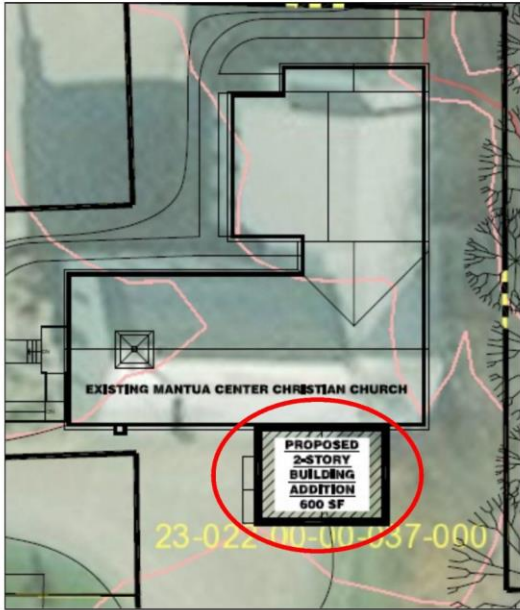

A compact addition (22 ft x 29 ft) with an elevator that provides compliant access to all levels of the building with a compliant rest room on each level and upgrades to the current kitchen

Keys to features on the plans

Lower Level

- A** New entrance doors off the south parking lot
- B** Elevator entrance
- C** Stairs up to Sanctuary level
- D** Current stairs at the corner of the Sanctuary to the corner of the Fellowship Hall to be removed
- E** Current window at the corner of the Fellowship Hall to be removed and converted to an open doorway to the Fellowship Hall from the new addition
- F** Current kitchen window to be removed and filled in
- G** New compliant restroom on the lower level
- H** Upgrades to the kitchen, to be determined by members' suggestions
- I** New windows, also along the south side (bottom on the page)

Upper Level

- A** Elevator exit to the Sanctuary level
- B** Elevator exit to the chancel and second floor level (21 inches higher than the Sanctuary level)
- C** Stairs to lower level
- D** New floor infill at the Sanctuary level (where current steps will be removed)
- E** Current window at the corner of the Sanctuary to be removed and converted to an open doorway to the Sanctuary from the new addition
- F** Current window in the upstairs storage room to be removed and converted into an open doorway to the chancel and second floor from the new addition
- G** New compliant restroom on the Sanctuary level
- H** Stairs from the Sanctuary level to the chancel and second floor
- I** New windows, also along the south side (bottom on the page)

Keys to features on the plans

Lower Level

- A** New entrance doors off the south parking lot
- B** Elevator entrance
- C** Stairs up to Sanctuary level
- D** Current stairs at the corner of the Sanctuary to the corner of the Fellowship Hall to be removed
- E** Current window at the corner of the Fellowship Hall to be removed and converted to an open doorway to the Fellowship Hall from the new addition
- F** Current kitchen window to be removed and filled in
- G** New compliant restroom on the lower level
- H** Upgrades to the kitchen, to be determined by members' suggestions
- I** New windows, also along the south side (bottom on the page)

Upper Level

- A** Elevator exit to the Sanctuary level
- B** Elevator exit to the chancel and second floor level (21 inches higher than the Sanctuary level)
- C** Stairs to lower level
- D** New floor infill at the Sanctuary level (where current steps will be removed)
- E** Current window at the corner of the Sanctuary to be removed and converted to an open doorway to the Sanctuary from the new addition
- F** Current window in the upstairs storage room to be removed and converted into an open doorway to the chancel and second floor from the new addition
- G** New compliant restroom on the Sanctuary level
- H** Stairs from the Sanctuary level to the chancel and second floor
- I** New windows, also along the south side (bottom on the page)

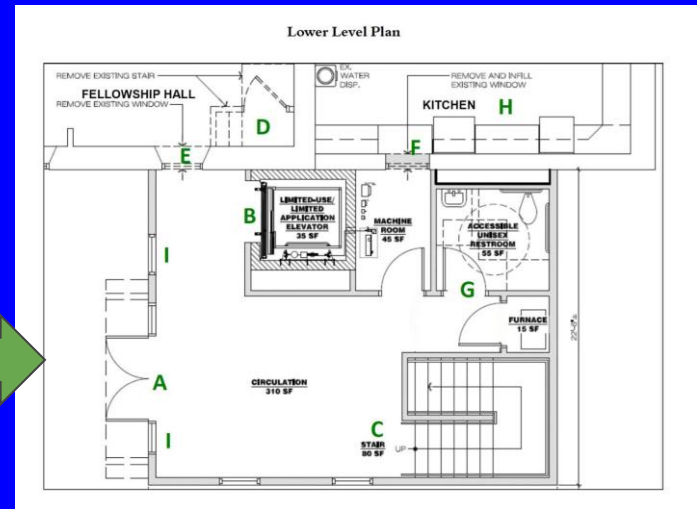

A key feature

The architect's problem:

- We have three levels in the building
- The sanctuary is 21 inches lower than the chancel and upper level

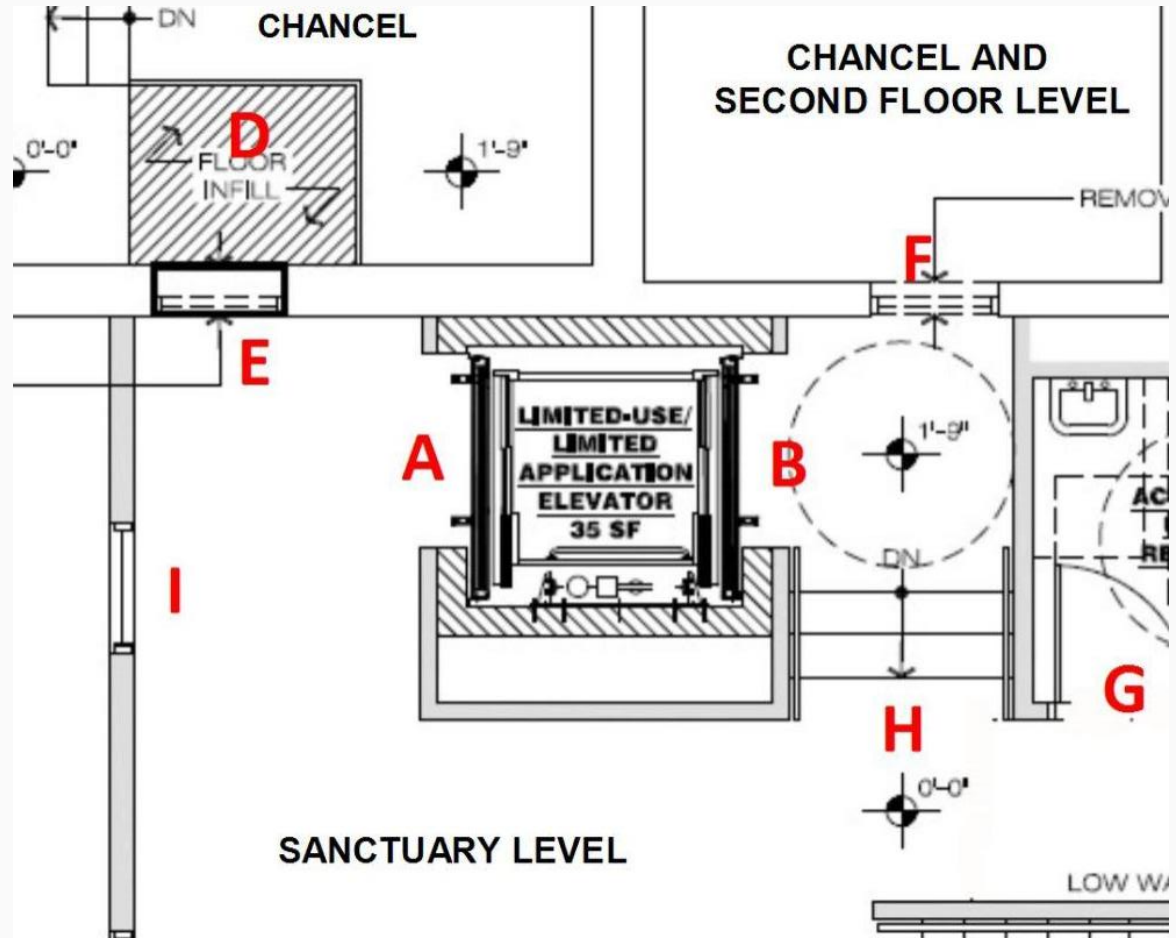

A key feature

The architect's solution:

- Use an elevator with two doors!
- The front door opens to the sanctuary level

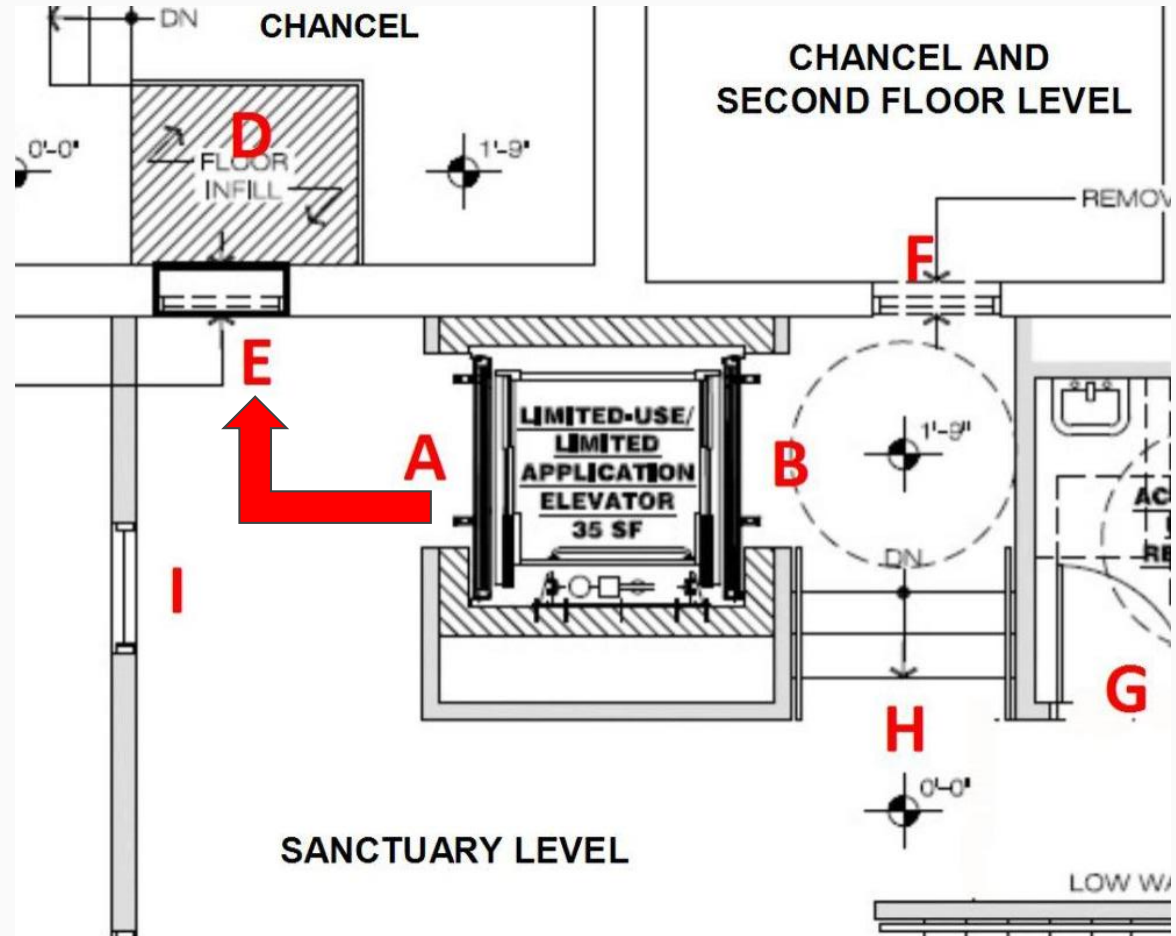

A key feature

The architect's solution:

- Use an elevator with two doors!
- The front door opens to the sanctuary level
- 21 inches higher, the rear door opens to the chancel and second floor level

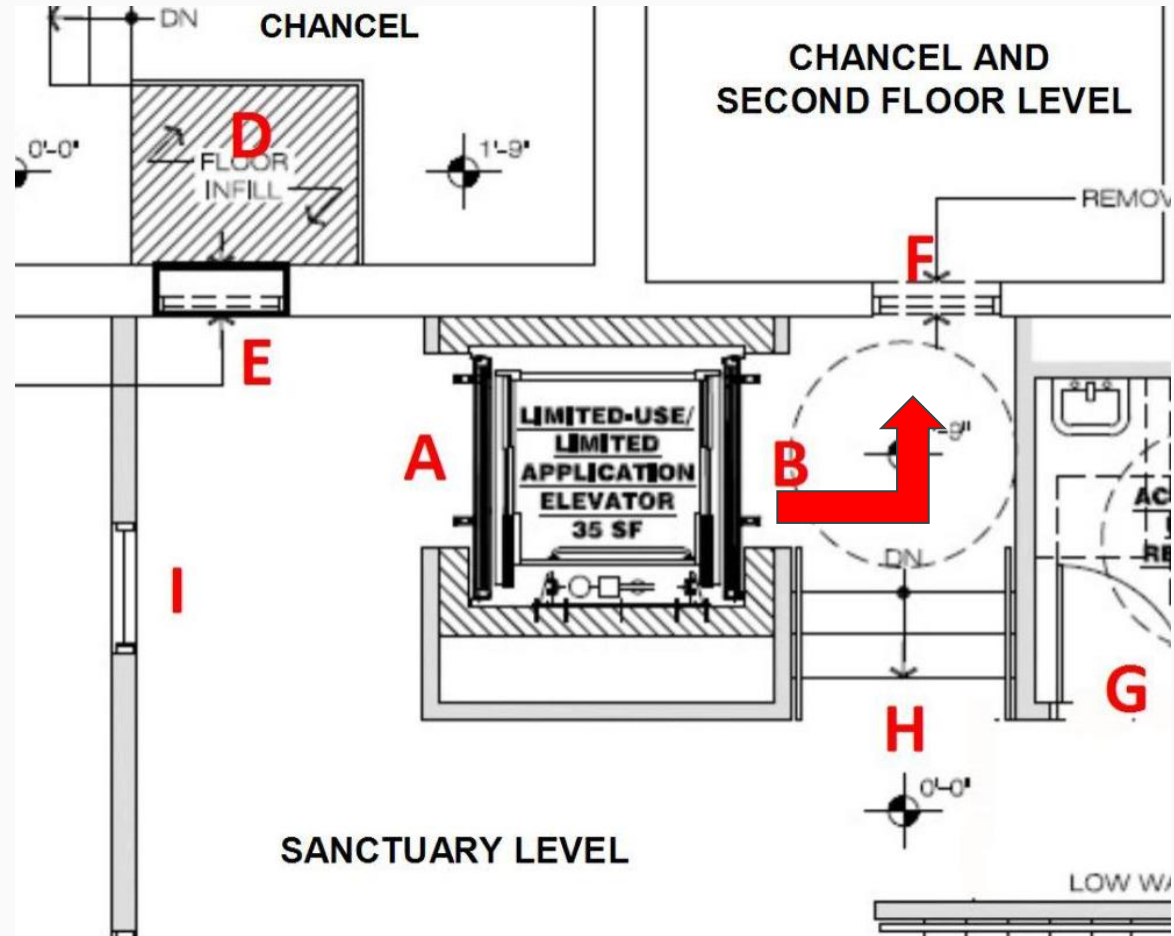

How much will it cost?

David Patterson, our architect, estimates the costs:

Two stories of 1,320 sq ft total x \$240 / sq ft = \$316,800

20% Contingencies = 63,600

Elevator = 110,000

Kitchen upgrades = 20,000

Pledge to Camp Christian Fund = 30,000

\$540,400

over three years

How much will it cost?

David Patterson, our architect, estimates the costs:

Two stories of 1,320 sq ft total x \$240 / sq ft = \$316,800
20%

*We'll put all of our
'begs' into one
'ask-it!'*

Kitchen upgrades = 20,000

Fund 20,000

Pledge to Camp Christian

\$540,400

over three years

Is this a good time to start a building project?

No, it is not – but we are not asking for money now;
the economy will improve over three years

A project like this under consideration will help us
attract a fine new pastor

We ask, now, only that you weigh the value of
the project and work to understand it

Members of the Third Century Team

Jon Secaur, Chair

Randy Alger

Pam Baynes

Linda Idoine

Karly Lind

Carol Magyarics

Brian Summerlin

Dottie Summerlin

Beth Voynovich



***We want to
hear from you!***